



输出功率：约0.2~3.0W  
精密金属齿轮减速电机

典型应用： 电子门锁  
智能家居  
智能机器人  
电动玩具

OUTPUT:APPROX 0.2~3.0W  
Precision Metal Gear Motor

Typical Applications: Electronic Door Lock  
Smart Home Appliance  
Smart Robot  
Electric Toys

## 1.OUTLINE DRAWING:

UNIT:MM

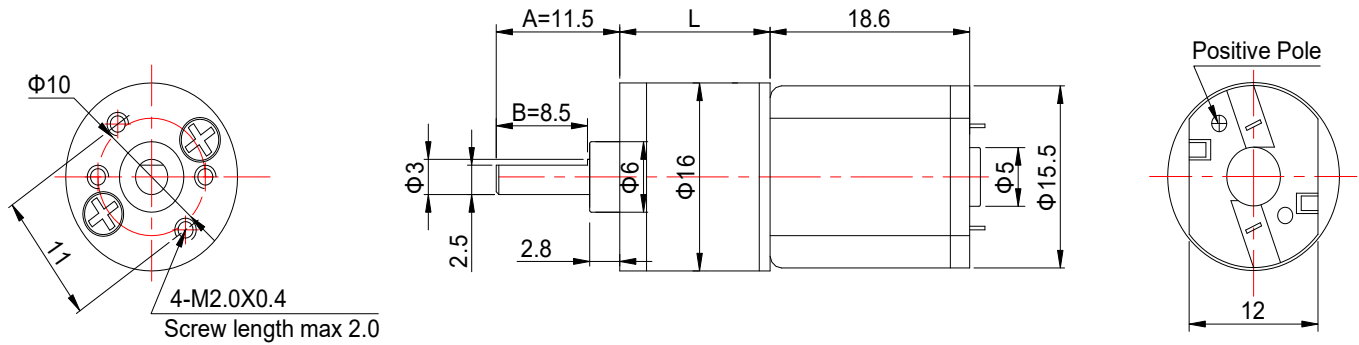

Customizable Parameters:

1. Length L、 A and B
2. Electric Performance
3. Output shaft specifications
4. Reduction Ratio

View:



WEIGHT: 26g(Approx)

## 2.GEARBOX REDUCTION RATIO:

Gearbox Length (mm)	Stage Number	Reduction Ratio					Rated Troque	Bearable Maximum Instant Torque
		kg.cm						
11	3	14/1					0.5	1.0
12.5	4	28/1	40/1				0.8	1.5
14	5	57/1	79/1	112/1			1.0	2.0
15.5	6	159/1	224/1	315/1			1.2	2.5
17	7	448/1	631/1	889/1			1.5	3.0

## 3.MOTOR PERFORMANCE :

1N.m $\approx$ 10.2kg.cm $\approx$ 14.2oz.in

MODEL	REDUCTION RATIO	VOLTAGE		NO LOAD		AT MAXIMUM EFFICIENCY				STALL	
		OPERATING RANGE	NOMINA	SPEED	CURRENT	SPEED	CURRENT	TORQUE	OUTPUT	TORQUE	CURRENT
			V	rpm	A	rpm	A	kg.cm	W	kg.cm	A
16GA030-14-061200	14/1	3.0~6.0	6.0	1200	0.08	945	0.06	0.06	0.58	0.29	1.12
16GA030-112-03120	112/1	2.0~4.0	3.0	120	0.1	96	0.42	0.36	0.35	1.8	1.65
16GA030-515-1225	515/1	5.0~12.0	12.0	25	0.05	19	0.16	1.6	0.31	6.45	0.48