



输出功率: 约0.2~8.0W
直流无刷电机

典型应用: 医疗器械
精密仪器
家用电器
美容仪器

OUTPUT: APPROX 0.2~8.0W
Brushless DC Motor

Typical Applications: Medical Instruments
Precision Instrument
Household Appliances
Beauty Equipment

1. OUTLINE DRAWING:

UNIT:MM

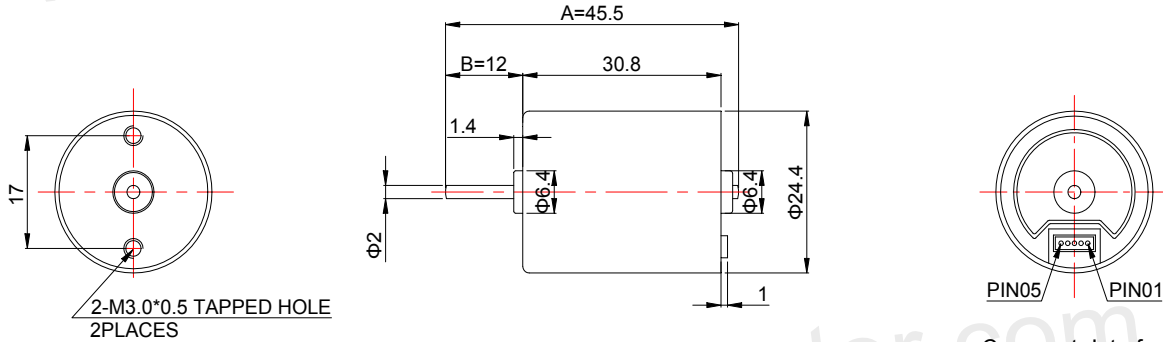

Connectr Interface

NO.	PIN ARRANGEMENT
1	VCC(Red Wire)
2	FG(Green Wire)
3	CW/CCW(Yellow Wire)
4	GND(Black Wire)
5	PWM(Blue Wire)

Customizable Parameters:
1. Length A and B
2. Electric Performance

WEIGHT: 50g(Approx)

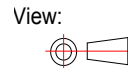

2. MOTOR PERFORMANCE :

MODEL	VOLTAGE		NO LOAD		AT MAXIMUM EFFICIENCY				STALL			
	OPERATING RANGE	NOMINAL V	SPEED rpm	CURRENT A	SPEED rpm	CURRENT A	TORQUE g.cm	TORQUE mN.m	OUTPUT W	TORQUE g.cm	TORQUE mN.m	CURRENT A
BL2430I-126300	8.0~15.0	12.0	6300	0.09	5150	0.41	65	6.38	3.43	362	35.53	1.84
BL2430-127500	8.0~15.0	12.0	7500	0.10	6100	0.41	50	4.91	3.13	265	26.01	1.75
BL2430I-249500	8.0~26.0	24.0	9500	0.09	7600	0.36	70	6.87	5.46	345	33.86	1.45

